

## INSTRUCTIONS :

934055  
NUMBER BOARDS

3 CHIME AIRHORN  
920011 BLACK  
920012 GRAY

BRAKE WHEEL  
933011 BLACK  
933016 YELLOW

SD70M BODYSHELL  
921561 NS 2608  
921562 UP 4841

920250  
SD70M GLASS SET

925200  
SD70M MECHANISM,  
COMPLETE (LESS TRUCKS)

SD70M  
HANDRAIL SET  
922191 BLACK  
922192 GRAY

922500  
MU HOSES

934023  
SNOW PLOW

CIRCUIT BOARD  
928040 WITH AMBER LED LIGHTS  
928047 WITH WHITE LED LIGHTS  
928053 W/GOLDEN WHITE LED

923510  
FLAT CENTERING SPRINGS  
(FOR CLIP MOUNT)

926030  
MOTOR FOR 6-AXLE UNITS

923520  
COUPLER CLIP

926510  
WORM BEARING AND JOINT SET

923512  
COUPLER TRIP PINS

902010  
INSULATING BUSHING

901010  
HEX NUT, 2MM

FUEL TANK  
924181 BLACK  
924182 GRAY

900040  
SCREW 2X7MM, ROUND HEAD

928500  
CIRCUIT BOARD POWER CLIPS

923500  
MAGNETIC KNUCKLE COUPLER,  
SHORT SHANK

923150  
MAGNETIC KNUCKLE COUPLER SET  
(SHORT & LONG)

SD70M TRUCK  
929321 BLACK  
929322 GRAY

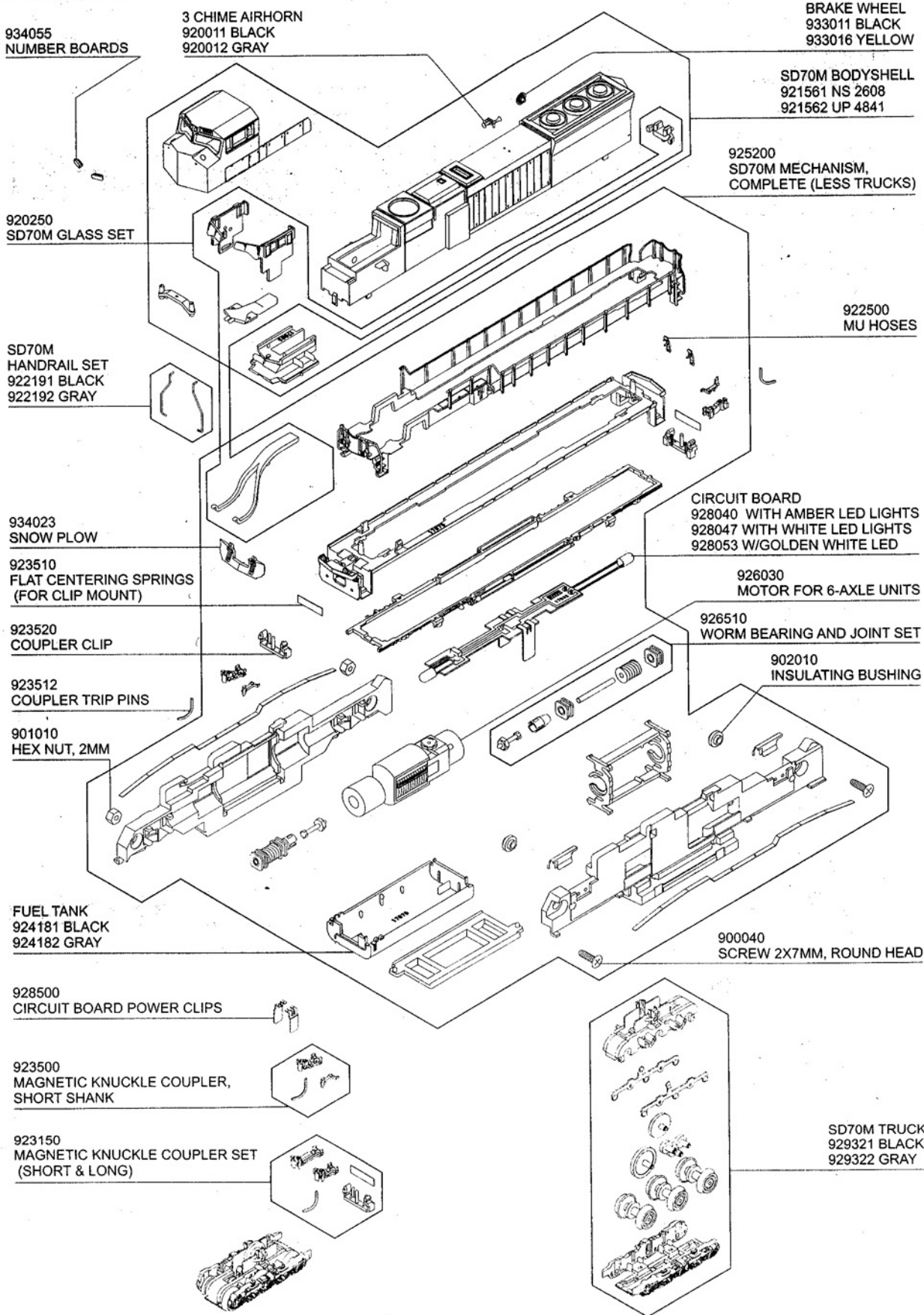

1. Pull to remove the pilot Coupler.
2. Remove the Coupler Pocket from the Body.
3. Put the Pilot Coupler Spring onto the Coupler Pocket.
4. Install the Coupler Pocket.
5. Press the Coupler into the Pilot Opening.

1. Pull to remove the pilot Coupler.
2. Remove the Coupler Pocket from the Body.
3. Put the Pilot Coupler Spring onto the Coupler Pocket.
4. Install the Coupler Pocket.
5. Press the Coupler Into the Pilot Opening.

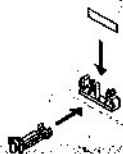

Push straight leg of Pin into oval shaped hole in Knuckle, noting the fit of the flattened shape of the Trip Pin. The Pin should clear the top of the rail by 0.010" (0.25mm) to prevent its snagging on switchers or grade crossings.

\*FULLY AUTOMATIC MAGNETIC KNUCKLE COUPLER PAT.

## LIMITED WARRANTY

1. Max. Operational voltage: 12V DC
2. Additional lubrication at time of purchase is not recommended.

KATO U.S.A., INC. warrants that this product will be free from defects in material and workmanship for a period of sixty(60)days from the date of purchase. If this product fails during the warranty period, carefully pack the assembled item in the original carton, together with the dated sales receipt, and return to: KATO U.S.A., INC. 100 Remington Road, Schaumburg, IL 80173. Defects due to misuse, improper maintenance and/or abuse are not covered by this warranty. Items that have been modified by the modeler or anyone other than an authorized KATO repair person are not covered by the warranty. This warranty gives you specific legal rights and you may also have other rights which vary from state to state.

ITEM #	DESCRIPTION	QUANTITY	ITEM #	DESCRIPTION	QUANTITY
900040	SCREW 2X7MM, ROUND HEAD, 6 EA	\$1.00	924181	FUEL TANK, BLACK, 1 EA	\$3.00
901010	HEX NUT, 2MM, 6 EA	\$1.00	924182	FUEL TANK, GRAY, 1 EA	\$3.00
902010	INSULATING BUSHING, 2MM, 6 EA	\$1.00	925200	SD70M MECHANISM, COMPLETE (LESS TRUCKS), 1 EA	\$50.00
920011	3 CHIME AIRHORN, BLACK, 2 EA	\$1.00	926030	MOTOR FOR 6-AXLE UNITS, 1 EA	\$29.00
920012	3 CHIME AIRHORN, GRAY, 2 EA	\$1.00	926510	WORM BEARING AND JOINT SET, 1 EA	\$4.00
920250	SD70M GLASS SET	\$5.00	928040	CIRCUIT BOARD WITH AMBER LED LIGHTS, 1 EA	\$6.00
921561	SD70M NS 2608 BODYSHELL, 1 EA	\$30.00	928047	CIRCUIT BOARD WITH WHITE LED LIGHTS, 1 EA	\$8.00
921562	SD70M UP 4841 BODYSHELL, 1 EA	\$30.00	928053	CIRCUIT BOARD W/GOLDEN WHITE LED, 1 EA	\$8.00
922191	SD70M HANDRAIL SET, BLACK	\$1.00	928500	CIRCUIT BOARD POWER CLIPS, 2 EA	\$2.00
922192	SD70M HANDRAIL SET, GRAY	\$1.00	929321	SD70M TRUCK, BLACK	\$12.00
922500	MU HOSES, 4 EA	\$1.00	929322	SD70M TRUCK, GRAY	\$12.00
923150	MAGNETIC KNUCKLE COUPLER SET (SHORT & LONG), 2 EA	\$4.00	933011	BRAKE WHEEL, BLACK	\$1.00
923500	MAGNETIC KNUCKLE COUPLER, SHORT SHANK, 8 EA	\$4.00	933016	BRAKE WHEEL, YELLOW	\$1.00
923510	FLAT CENTERING SPRINGS (FOR CLIP MOUNT), 8 EA	\$1.00	934023	SNOW PLOW, 1 EA	\$1.00
923512	COUPLER TRIP PINS, 8 EA	\$1.00	934055	NUMBER BOARDS, 2 EA	\$1.00
923520	COUPLER CLIP, 4 EA	\$1.50			

Check Here if Color Substitutions are Acceptable If Selected Color Choice is not Available. ☐

**ORDERED BY:** Hours : Mon-Fri 9:00 a.m. to 12:00 p.m. or 1:00 p.m. to 4:00 p.m. Central Time (Except Holidays)

Name	
Address	Phone
City	State Zip
Daytime Phone Number Area Code( )	

<b>SHIP TO:</b>		
Name		
Address		Phone
City	State	Zip

<b>METHOD OF PAYMENT (U.S. Funds Only)</b> <input type="checkbox"/> Check <input type="checkbox"/> Money Order <input type="checkbox"/> Mastercard <input type="checkbox"/> VISA (Allow two weeks for check clearance)	
Credit Card Number	Expiration Date
Signature	3 Digit Code Number from Card Back

<b>Phone Orders</b> 1-800-548-5286 Kato Parts Department	<b>Fax Orders</b> 847-781-9570 Fax your order form	<b>Mail Orders</b> 100 Remington Road Schaumburg IL 60173
--	--	---

[illegible]

Please add to Shipments:

**\$5.00 U.S.A. Canada and Mexico**  
\$9.99 to 2999, foreign country

**SHIPPING & HANDLING**

TOTAL DUE